

Proposed Project at Mouza-Adlabad, J.L. No-28, Dag No-45/540 & 45/541, L.R. Khatian No-377 & 378, Ward No-14, Vill-Adlabad, under Egra Block-1, P.O. & P.S.- Egra, District-Purba Medinipur, Pin-721429

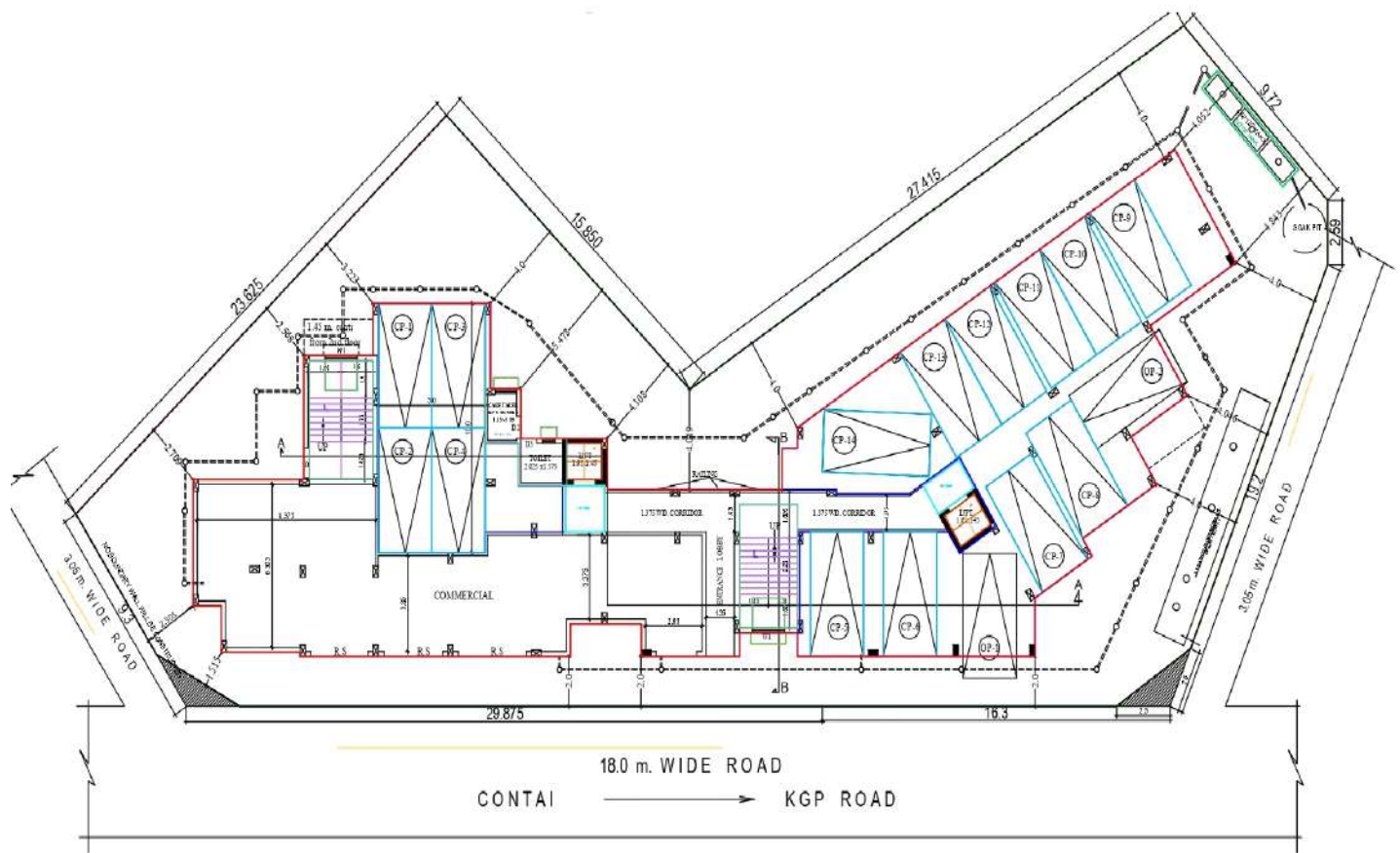

LATITUDE : 26.166290
LONGITUDE : 46.534761

TINKU KUMAR PATRA
Tinku Kumar Patra
Proprietor

SIGNATURE OF OWNER